

Teacher Access Center Missing Favorite

1. Visit the CISD website, and choose the **Employee** link.



2. Choose the appropriate link, depending on your location.

- [eSchool Plus - internal login](#) || [external login](#)

on campus

at home

3. When you are successfully logged in, choose **Favorites > Add to Favorites**.

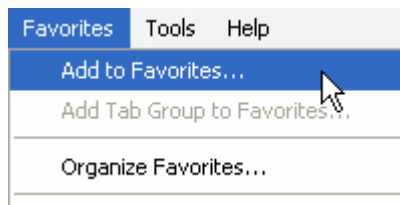

4. Rename.

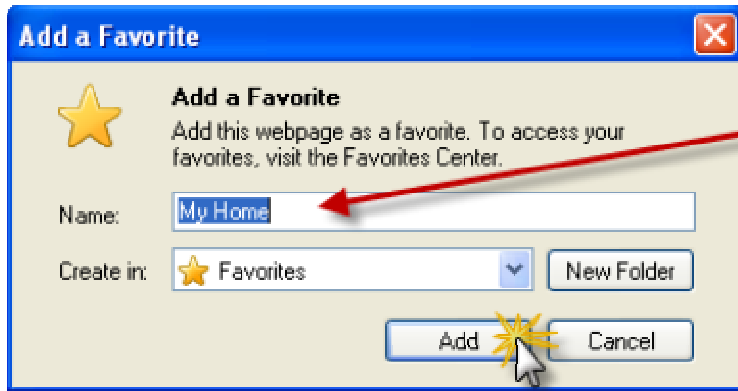

type new name -
call it Channelview ISD eSchoolPlus

5. Click **Add**. (Internet Explorer version 6 – click **OK**.)